

Installation Step 1:

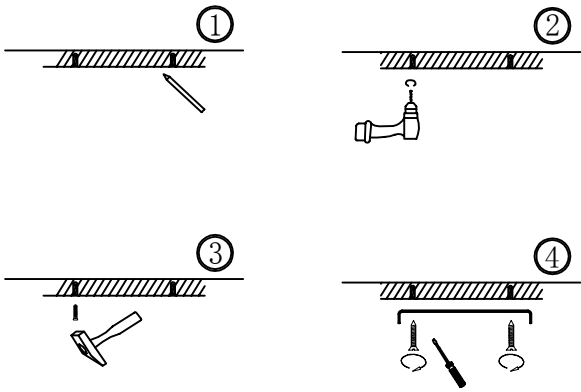

1. During installation, take out the hanging board and align it with the corresponding position of the ceiling. Use a pen to draw the punching position (Figure 1)
2. Then use an electric drill to drill a hole at the marked position (Figure 2)
3. Use the hammer to align the corresponding holes to fix the plastic glue drop (Figure 3)
4. Fix the lamp hanging plate with self-tapping screws (Figure 4)

Installation Step 2:

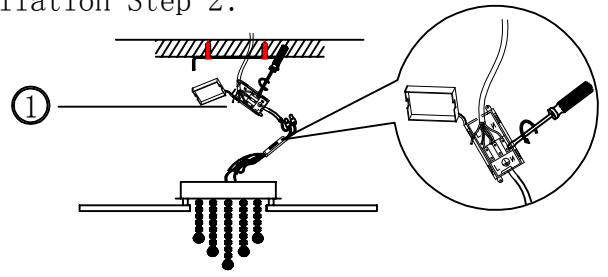

1. Lift the lamp and connect the power cord of the lamp with the household (110V) wire reserved for the ceiling with a screwdriver (Figure 1)

Installation Step 3:

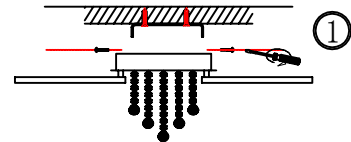

1. After connecting the power cord, fix the lamp body and the hanging board with screws (Figure 1)

Installation Step 4:

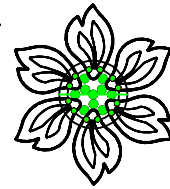

Assembly Diagram

Assembled fixed indication diagram 1

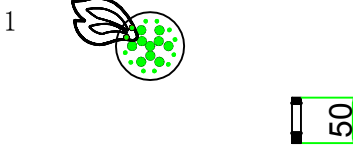

1. First take out the screw accessories from the accessory bag.
2. Fix the lamp holder 1 on the chassis with screws.

Assembled fixed indication diagram 2

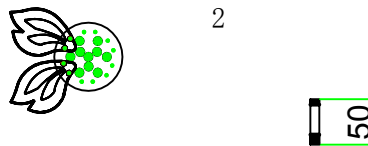

1. First take out the screw accessories from the accessory bag.
2. Fix the lamp holder 2 on the chassis with screws.

Assembled fixed indication diagram 3

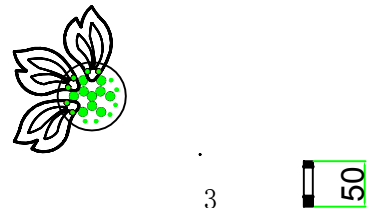

1. First take out the screw accessories from the accessory bag.
2. Fix the lamp holder 3 on the chassis with screws.

Assembled fixed indication diagram 4

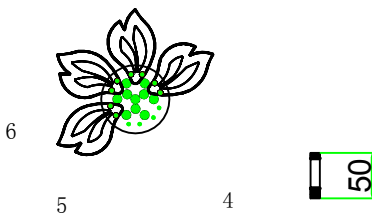

1. First take out the screw accessories from the accessory bag.
2. Fix the lamp holder 4/5/6 on the chassis with screws.

Assembled fixed indication diagram 5

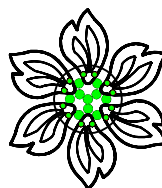

1. First take out the screw accessories from the accessory bag.
2. Fix the lamp holder 7/8/9 on the chassis with screws.

Diagram of circuit docking assembly

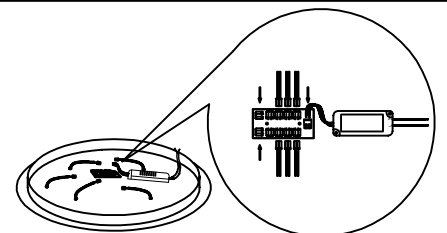

1. First, plug the male plug of the drive group A with the female plug of the group A.
2. Connect the male plug of the lamp cap cord to the female plug of the second lamp cap cord
3. Check whether the male and female plugs are properly inserted, and install after the test light on the ceiling.